

N/MALE-FME/PLUG ADAPTER

SM6107

SPECIFICATIONS

ELECTRICAL

FREQUENCY: 0-2 GHZ
IMPEDANCE: 50 OHMS
WORKING VOLTAGE: 335 V rms @ SEA LEVEL

MECHANICAL

MATERIALS BODY: NICKEL PLATED BRASS
CONTACT: BRASS
CONTACT PLATING: AU 3 μ

TEMPERATURE RANGE: -65° - +85°

THREAD SIZE

N/MALE: 5/8-24 UNEF-2B
FME/PLUG: M8 X P0.75-6H

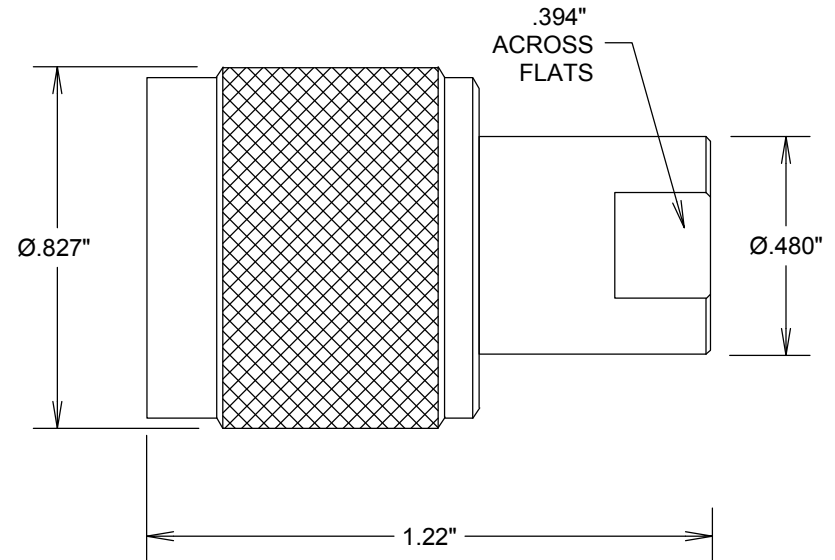

FAIRVIEW MICROWAVE INC.

ALLEN, TX 75013 WWW.FAIRVIEWMICROWAVE.COM

TITLE

N/MALE-FME/PLUG ADAPTER

SIZE	CAGE CODE	DWG NO	REV
A	3FKR5	SM6107	--

SCALE

SHEET