

## SMA Female to 1.85mm Male Adapter

SMA female to 1.85mm male adapter part number FMAD1202 from Fairview Microwave is in-stock and ships same day. This Fairview SMA to 1.85mm adapter has a female to male gender configuration. FMAD1202 SMA female to 1.85mm male adapter operates to 26.5 GHz. The Fairview Microwave RF adapter provides excellent VSWR of 1.2:1 maximum. The SMA connector mates mechanically with commercially available 3.5mm and 2.92mm (K) connectors. The 1.85mm connector mates mechanically with commercially available 2.4mm connectors.

RF adapters can be used to enable connections between two connector types that would otherwise not mate. Certain RF adapter configurations can also be used to protect connectors on expensive equipment where the number of connect and disconnect cycles is high. An RF, microwave, or millimeter wave adapter is connected to the equipment and the commonly changed connection is made with the adapter which can be easily replaced when it wears out after high usage; such adapters are referred to as connector savers. Fairview Microwave also offers bulkhead, panel mount, hermetically sealed, reverse polarity, and isolated ground adapter varieties to serve all of your RF, microwave and millimeter wave needs.

### Electrical Specifications

| Description     | Min | Typ | Max   | Units |
|-----------------|-----|-----|-------|-------|
| Frequency Range | DC  |     | 26.5  | GHz   |
| VSWR            |     |     | 1.2:1 |       |

### Mechanical Specifications

**Size**  
Length 0.747 in [19.0 mm]

| Description | Connector 1 | Connector 2 |
|-------------|-------------|-------------|
| Type        | SMA Female  | 1.85mm Male |
| Polarity    | Standard    | Standard    |

### Material Specifications

| Description            | Connector 1                | Connector 2                |
|------------------------|----------------------------|----------------------------|
| Type                   | SMA Female                 | 1.85mm Male                |
| Contact Material       | Beryllium Copper           | Beryllium Copper           |
| Contact Plating        | Gold                       | Gold                       |
| Outer Contact Material | Passivated Stainless Steel |                            |
| Body Material          |                            | Passivated Stainless Steel |
| Coupling Nut Material  |                            | Passivated Stainless Steel |

**Compliance Certifications** (see [product page](#) for current document)

### Plotted and Other Data

Notes:



### Configuration:

- SMA Female Connector 1
- 1.85mm Male Connector 2
- 50 Ohm
- Straight Body Geometry

### Features:

- VSWR of 1.2:1 max up to 26.5 GHz
- Gold Plated Beryllium Copper Contact

### Applications:

- Enables Between Series Connections
- General Purpose Test

Fairview Microwave  
301 Leora Ln., Suite 100  
Lewisville, TX 75056  
Tel: 1-800-715-4396 / (972) 649-6678  
Fax: (972) 649-6689  
[www.fairviewmicrowave.com](http://www.fairviewmicrowave.com)  
[sales@fairviewmicrowave.com](mailto:sales@fairviewmicrowave.com)

SMA Female to 1.85mm Male Adapter from Fairview Microwave is in-stock and available to ship same-day. All of our RF/microwave products are available off-the-shelf from our ISO 9001:2008 certified facilities in Lewisville, Texas. Fairview Microwave is RF on-demand.

For additional information on this product, please click the following link: [SMA Female to 1.85mm Male Adapter FMAD1202](#)

URL: <https://www.fairviewmicrowave.com/sma-female-1.85mm-male-adapter-fmad1202-p.aspx>

The information contained in this document is accurate to the best of our knowledge and representative of the part described herein. It may be necessary to make modifications to the part and/or the documentation of the part, in order to implement improvements. Fairview Microwave reserves the right to make such changes as required. Unless otherwise stated, all specifications are nominal. Fairview Microwave does not make any representation or warranty regarding the suitability of the part described herein for any particular purpose, and Fairview Microwave does not assume any liability arising out of the use of any part or documentation.

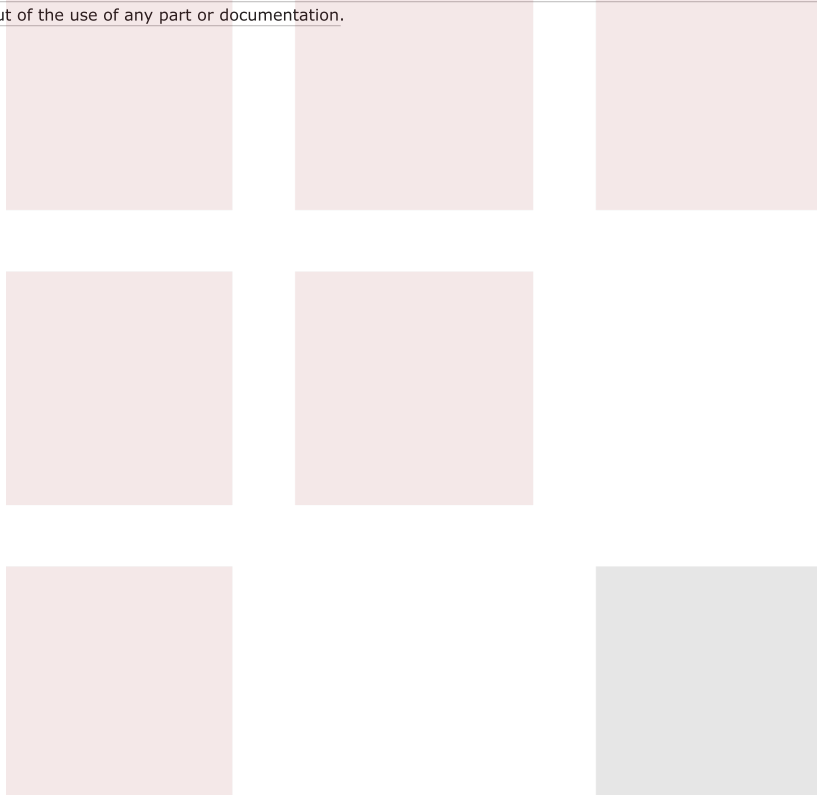

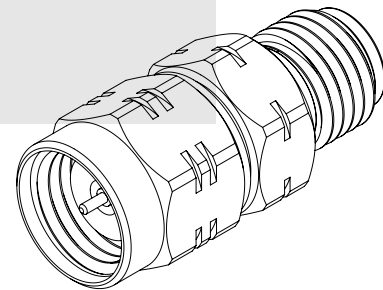
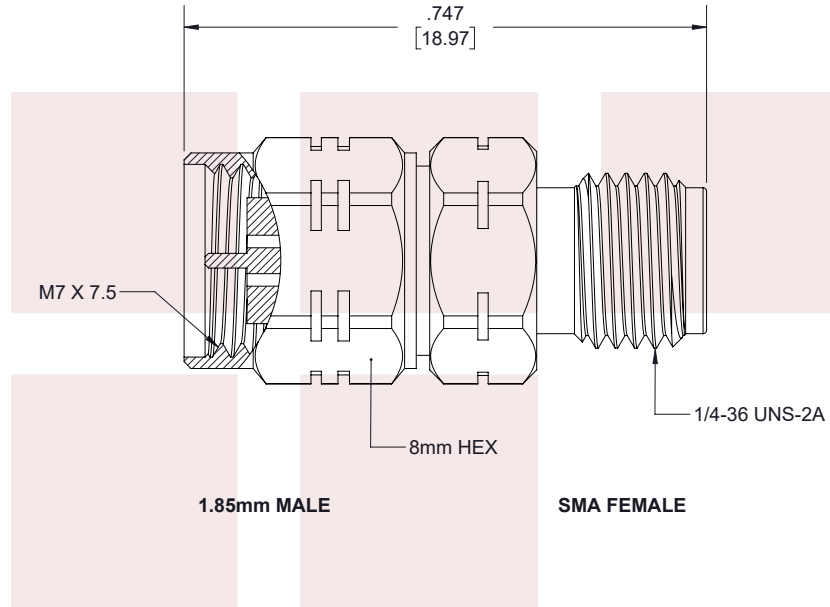

**STANDARD TOLERANCES**

.X  $\pm 0.2$   
.XX  $\pm 0.01$   
.XXX  $\pm 0.005$

\*STANDARD TOLERANCES APPLY ONLY TO DIMENSIONS IN INCHES

NOTES:  
1. UNLESS OTHERWISE SPECIFIED ALL DIMENSIONS ARE NOMINAL.  
2. ALL SPECIFICATIONS ARE SUBJECT TO CHANGE WITHOUT NOTICE AT ANY TIME.  
3. DIMENSIONS ARE IN INCHES [mm].

|  |                      |                 |                    |           |      |  |
|--|----------------------|-----------------|--------------------|-----------|------|--|
| TITLE<br>SMA Female to 1.85mm Male Adapter | DWG NO<br>FMAD1202   |                 | CAGE CODE<br>3FKR5 |           |      |  |
|  | CAD FILE<br>05/09/18 | SHEET<br>1 OF 1 | SCALE<br>N/A       | SIZE<br>A | 7361 |  |